

V1.1

INSTALLATION  
GUIDE



CAR MEDIA SYSTEMS



VN1015-MA-DAB-4G

**INFOTAINMENT**  
**TOUCHSCREEN NAVICEIVER**  
VISION SERIES FOR ANDROID™

## IMPORTANT NOTES

---

**This guide is an aid for the professional installation of the device.**

**Please note the following notes before installation:**

- Always handle all parts of the device and the components of your vehicle with care.
- Under all circumstances observe the regulations of the vehicle manufacturer and do not make any changes to the vehicle which could impair driving safety.
- For safety reasons, disconnect the vehicle battery's ground connection before installation.
- Please always pay attention to the correct polarity of the connections.
- Please do not modify any harnesses or connections of the device or the vehicle as this may affect the warranty.
- Make sure that no cables are squashed or cause a short circuit.
- Do not lay cables in front of the airbags, e.g. in the dashboard or in a way that affects their function.

## RECOMMENDED TOOLS

---



**Phillips screwdriver**



**Unlocking tools**



**Cable ties**

## ASSEMBLY OF THE DEVICE

---

### IMPORTANT NOTE:

Many vehicle models require a vehicle-specific 2-DIN INSTALLATION SET for a professional installation in the vehicle. In order to use the existing steering wheel remote control of your vehicle, a vehicle-specific adapter may also be required. Information can be obtained on the Internet or from your specialist dealer.

Connect all required connections to the main device (See page 6).

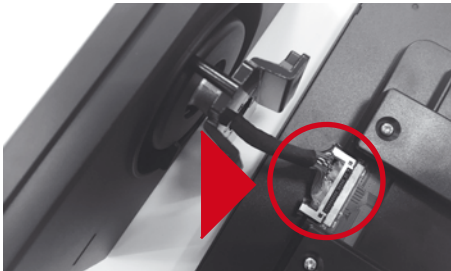
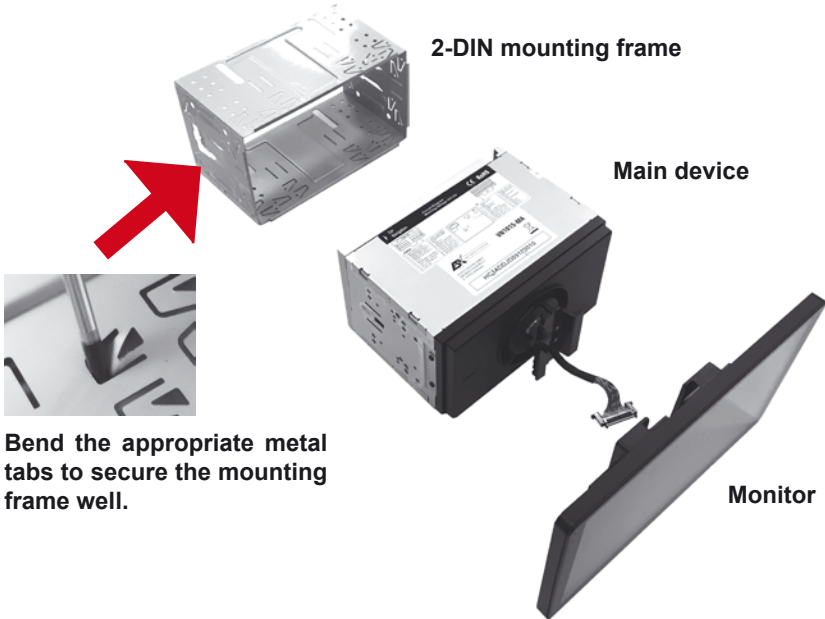





Connect the plug of the monitor to the main device.





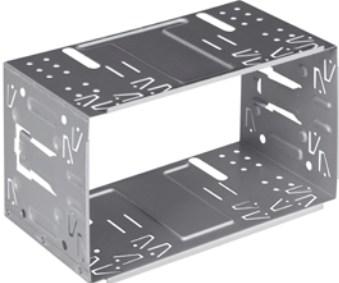

Slide the monitor onto the fixture on the main device by unlocking the two retaining clips on the side.

## SCOPE OF DELIVERY

ITEM	FIGURE	QUANTITY
Main device		1
Monitor		1
2-DIN mounting frame		1
System connector standard		1
AV connector with all audio and video connections and additional USB port		1

## SCOPE OF DELIVERY

ITEM	FIGURE	QUANTITY
GPS antenna	 A small, square, black GPS antenna with a black cable and a yellow connector.	1
DAB antenna	 A DAB antenna consisting of a black cable with a yellow connector, a black rectangular antenna head, and a white mounting bracket.	1
4G/LTE antennas	 Two black, rectangular 4G/LTE antennas, each with a black cable and a yellow connector.	2
4G/LTE dongle	 A black 4G/LTE dongle with a black cable and a yellow connector.	1

## MICRO SD SLOT FOR NAVIGATION SOFTWARE

---

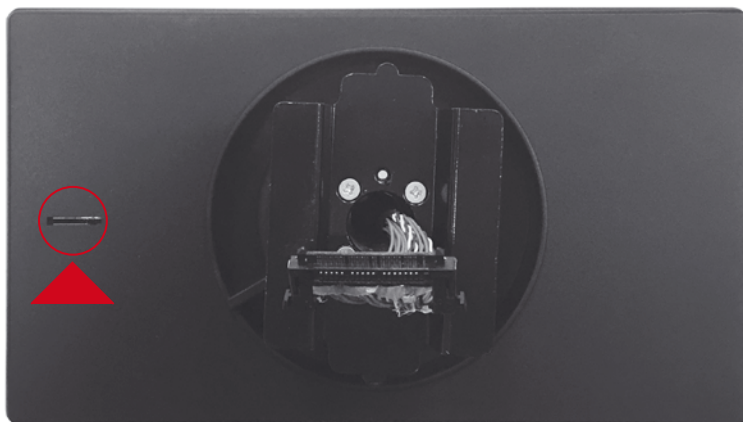

Here you can insert the MicroSD card of the navigation software. For the device to have access, you may need to assign the access path in the Apps menu under “Settings”.

## RESET BUTTON

---

If the device stops responding to input, the system is overloaded or crashed. Then reboot the system by pressing the reset button (RST) on the front panel. Use a suitable object, such as a paper clip or a ballpoint pen. After pressing the reset button, the system restarts without losing your previous settings.



## CAMERA DIRECT BUTTON

---

If you have connected an optional rear-view camera, you can show or hide its image signal at any time with the button marked below, regardless of whether reverse gear is engaged.



# WIRING DIAGRAM

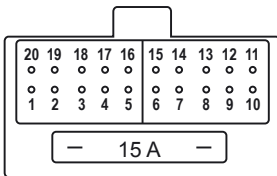
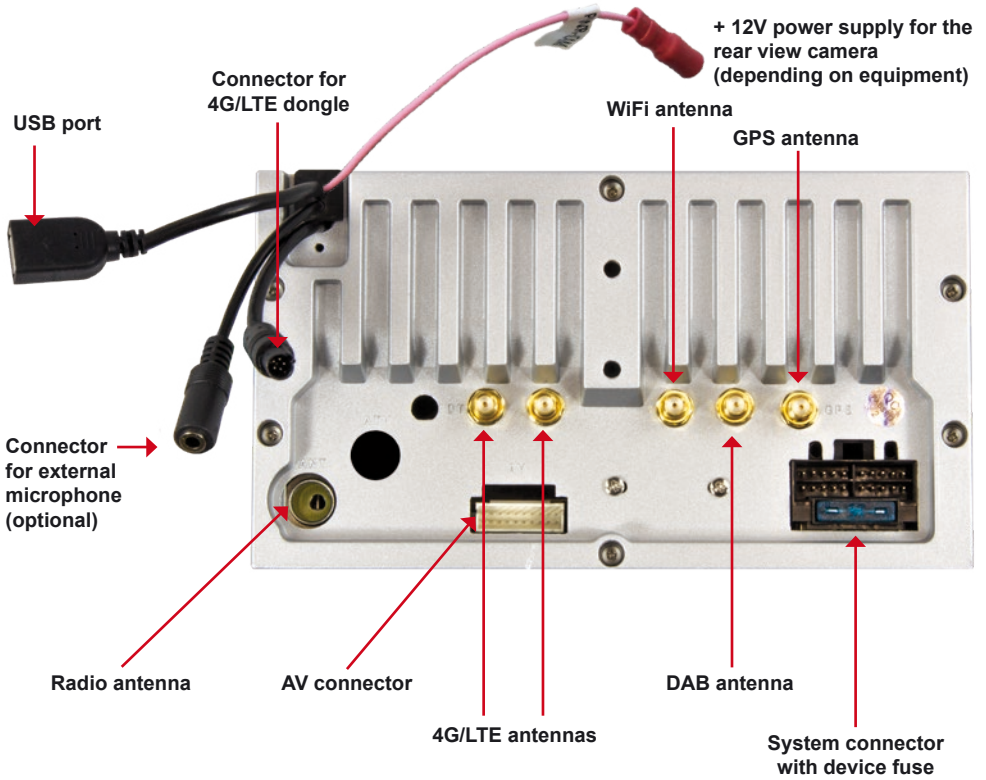

- |                       |                        |
|-----------------------|------------------------|
| 1 BATTERY (+12V)      | 11 LIGHT CONTROL       |
| 2 REAR RIGHT OUT (+)  | 12 STEERING GND        |
| 3 FRONT RIGHT OUT (+) | 13 KEY1                |
| 4 REAR LEFT OUT (-)   | 14 CAN -TX             |
| 5 FRONT LEFT OUT (-)  | 15 BRAKE CONTROL       |
| 6 ACC +               | 16 FRONT LEFT OUT (+)  |
| 7 REVERSE CONTROL     | 17 REAR LEFT OUT (+)   |
| 8 ANT/AMP CONTROL     | 18 FRONT RIGHT OUT (-) |
| 9 KEY2 (SPARE BIT)    | 18 REAR RIGHT OUT (-)  |
| 10 CAN-RX             | 20 GND (BATTERY -)     |

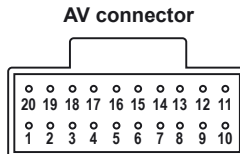

- |                     |                   |
|---------------------|-------------------|
| 1 VIDEO OUT 2       | 11 FRONT LEFT OUT |
| 2 GND               | 12 SUBWOOFER OUT  |
| 3 VIDEO OUT 1       | 13 GND            |
| 4 CAMERA IN         | 14 AUX IN-LEFT    |
| 5 GND               | 15 GND            |
| 6 AUX VIDEO IN      | 16 AUX IN-RIGHT   |
| 7 AMPLIFIER CONTROL | 17 GND            |
| 8 REAR RIGHT OUT    | 18 USB-DP         |
| 9 REAR LEFT OUT     | 18 USB-DN         |
| 10 FRONT RIGHT OUT  | 20 USB +5V        |



## INSTALLATION HINTS

---

### **Handbrake connection:**

Depending on the type of vehicle the CAN-BUS sends the information of the handbrake signal to the ESX device. If this is not the case, the included cable needs to be connected. The signal must be connected with ground while the handbrake is applied. Please contact for a proper and safe installation your car dealer! According to legal regulations, the device must playback a DVD or video on the main screen only with the handbrake applied, Never connect the cable permanently with the vehicle's ground. To prevent accidents by inattention while driving, the screen is blanked. The video outputs (10) are not affected.

### **GPS antenna:**

The GPS antenna must be mounted horizontally in front on the dashboard (ensure a clear view to the sky). A metalized windscreen allows no reception. If a factory GPS antenna with the same connector type is already available, it can be used. Then the installation of the included GPS antenna is not necessary.

### **DAB antenna:**

Lay the adhesive DAB antenna to the windshield and fasten it there.

### **USB ports:**

Lay the USB cables to the desired location, such as in the glove compartment. If necessary, openings have to be drilled for this purpose.

## SETUP THE 4G/LTE INTERNET CONNECTION

---

1. First lay the two 4G/LTE antennas inside the dashboard towards the windshield, one antenna for the left and one for the right.
2. Ideally, you should stick the antennas to the windshield to ensure optimal reception.
3. Then insert your SIM card in the 4G/LTE dongle:



Open the dongle by pushing the flap to the right.

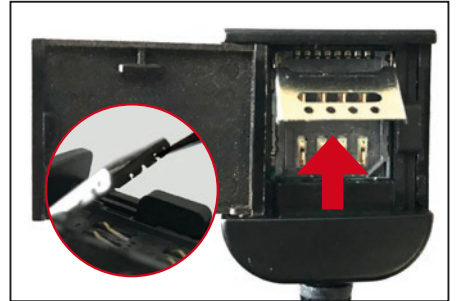

Now open the metal flap carefully with a suitable tool by pushing the flap up.

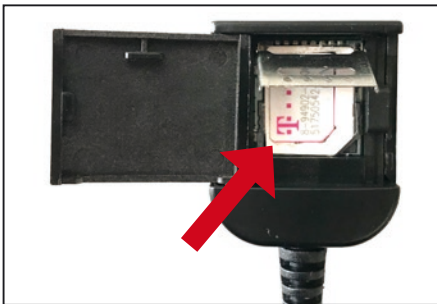

Then insert your SIM card with the contacts facing down.

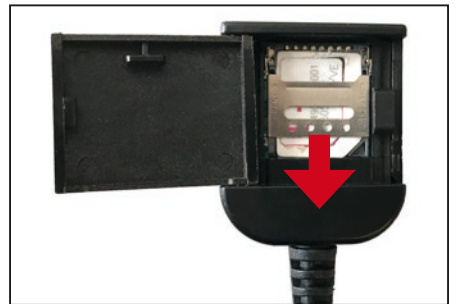

Close and lock the metal flap carefully by pushing the flap down.

### Compatible SIM cards:



Micro SIM



Nano SIM with adapter for Micro SIM

## SETUP THE 4G/LTE INTERNET CONNECTION

---

### 4. Then turn on the device to test the 4G/LTE connection.



After the device has started, enter your 4-digit PIN code of the SIM card here. Confirm the entry with the tick.

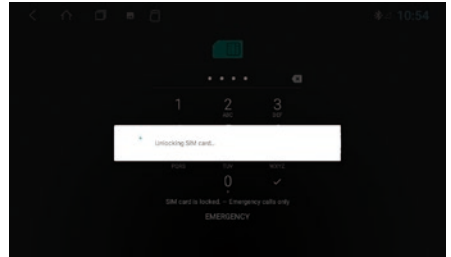

After successful entry, the SIM card is unlocked.



If the device is successfully connected to the mobile Internet, the „4G“ symbol appears in the status bar at the top right.

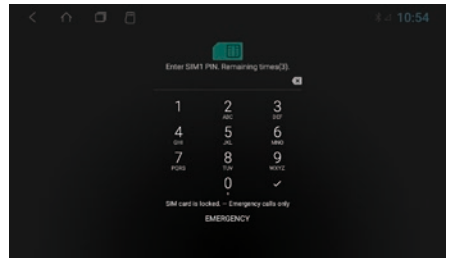

If the device is turned off, you have to enter the PIN code of the SIM card again after each restart, just like with a smartphone.

### 5. After a successful test, install the 4G/LTE dongle in the radio slot or dashboard.



CAR MEDIA SYSTEMS



ESX Car Media Systems · Audio Design GmbH  
Am Breilingsweg 3 · D-76709 Kronau/Germany  
Tel. +49 7253 - 9465-0 · Fax +49 7253 - 946510  
[www.esxnavi.de](http://www.esxnavi.de) - [www.audiodesign.de](http://www.audiodesign.de)

© All rights reserved. Technical changes, errors and mistakes reserved.